

DOOR INFILL – INSULATED

DOOR INFILL

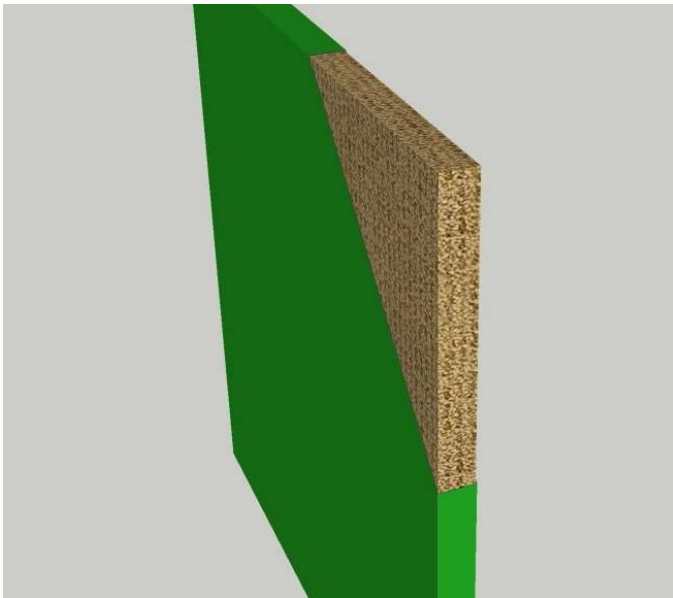
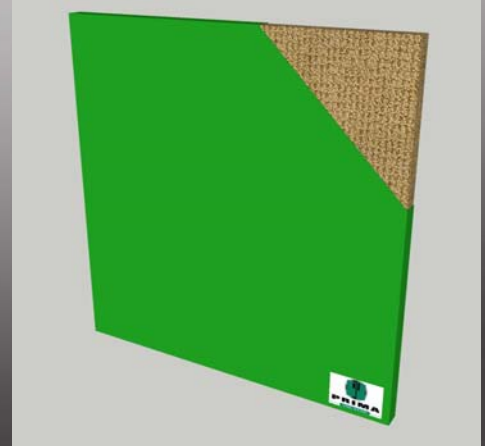

Ref
Insulated Infill

Leaf Specification

Zintec Outer Skin (1.2mm)
Rockwool Lamella Infill (47.6mm)
Zintec Inner Skin (1.2mm)

Total Leaf Thickness = 50mm

Application

- SteelGuard (Insulated)