

DOOR INFILL – ACOUSTIC

DOOR INFILL

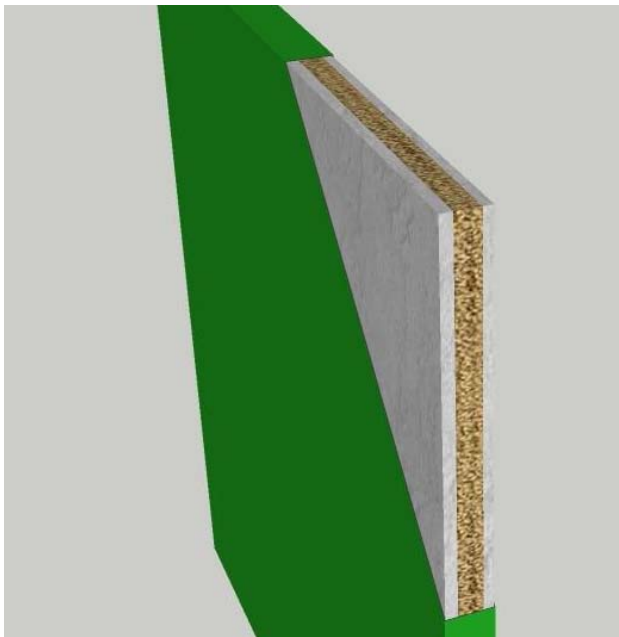
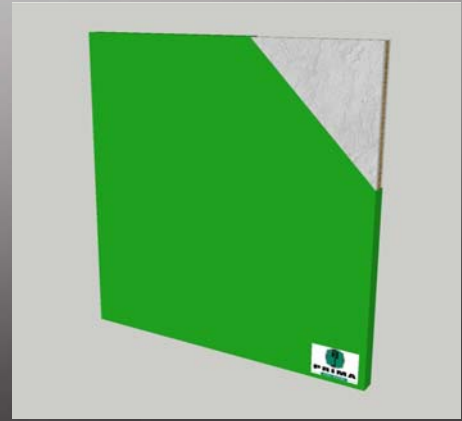

Ref
Acoustic Infill

Leaf Specification

Zintec Outer Skin (1.2mm)
Plasterboard (10mm)
Rockwool Lamella (25mm)
Plasterboard (12.5mm)
Zintec Inner Skin (1.2mm)

Total Leaf Thickness = 50mm

Application

- SoundGuard (Grade 3 & 4)