

MORTICE BATHROOM CASE

ARRONE®

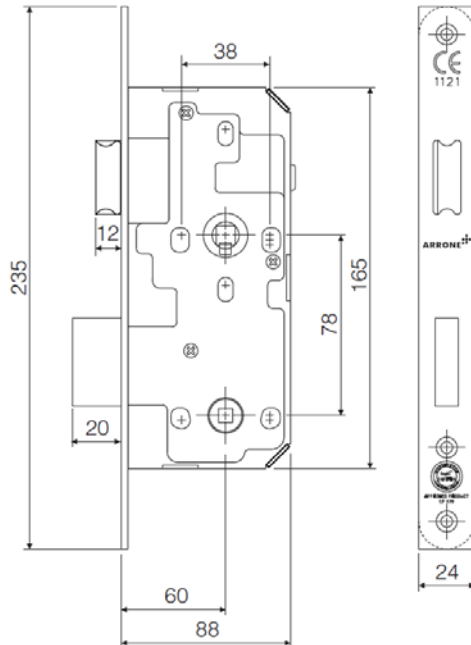

BATHROOM CASE



Ref
AR913-S-60-SSS

Standard
BS EN12209: 2003

Fire
BS EN1634 Part 1: 2000

CE Marked
1121-CPD-AG0069

Certifire Approved
CF530

DDA
Meets BS8300 & doc M

Case

Mild steel/black powder coated finish, pierced to accept bolt through furniture and escutcheons with 38mm centres.

Position on Door

926mm from bottom of leaf to centre of cylinder.

Follower

8mm zinc alloy follower (high copper content for additional strength) with spindle gripping feature

Backset

60mm

Latchbolt

Nickel plated solid brass guided latchbolt, easily reversible without opening case.

Deadbolt

Zinc alloy single throw with 20mm projection (high copper content for additional strength)

Forend

Square forend - Satin Stainless Steel

Application

SteelGuard, Flame Guard, SoundGuard, MarineGuard, SportsGuard