

EUROPROFILE MORTICE DEADLOCK

ARRONE®

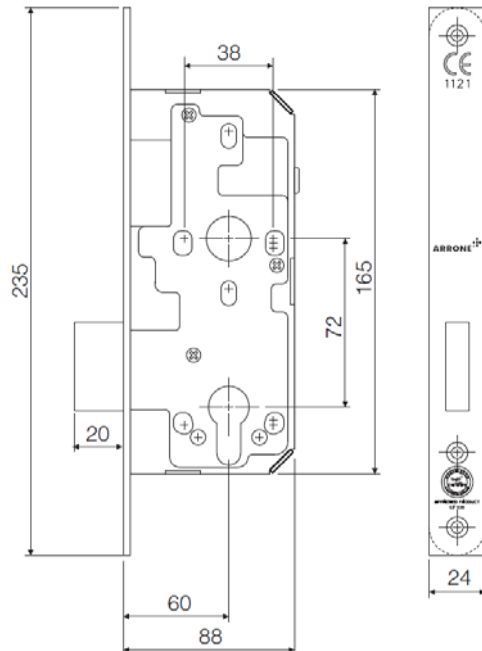

DEADLOCK



Ref
AR912-S-60-SSS

Standard
BS EN12209: 2003

Fire
BS EN1634 Part 1: 2000

CE Marked
1121-CPD-AG0068

Certifire Approved
CF530

DDA
Meets BS8300 & doc M

Case

Mild steel/black powder coated finish, pierced to accept bolt through furniture and escutcheons with 38mm centres.

Position on Door

Central: 800mm from bottom of leaf to centre of cylinder.

High: 1450mm from bottom of leaf to centre of cylinder.

Low: 470mm from bottom of leaf to centre of cylinder.

Backset

60mm

Deadbolt

Zinc alloy single throw with 20mm projection (high copper content for additional strength)

Forend

Square forend - Satin Stainless Steel

Application

SteelGuard, SecureGuard (Grades 1-4), Flame Guard, SoundGuard, MarineGuard, SportsGuard