

## EUROPROFILE MORTICE SASHLOCK

ARRONE®

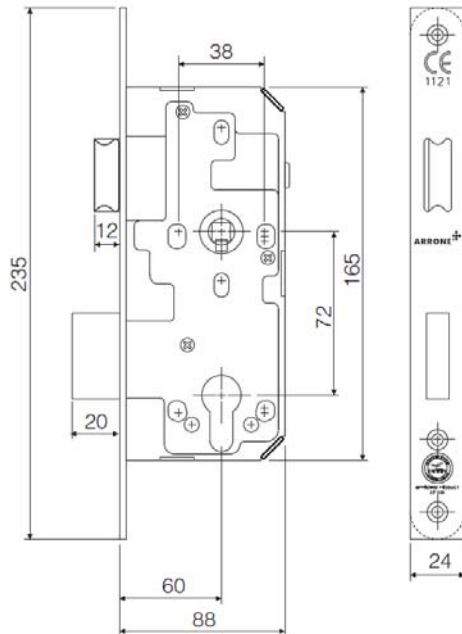

SASHLOCK



**Ref**  
AR910-S-60-SSS

**Standard**  
BS EN12209: 2003

**Fire**  
BS EN1634 Part 1: 2000

**CE Marked**  
1121-CPD-AG0067

**Certifire Approved**  
CF530

**DDA**  
Meets BS8300 & doc M

### Case

Mild steel/black powder coated finish, pierced to accept bolt through furniture and escutcheons with 38mm centres.

### Position on Door

926mm from bottom of leaf to lock cylinder.

### Follower

8mm zinc alloy follower (high copper content for additional strength) with spindle gripping feature

### Backset

60mm

### Latchbolt

Nickel plated solid brass guided latchbolt, easily reversible without opening case.

### Forend

Square forend - Satin Stainless Steel

### Deadbolt

Zinc alloy single throw with 20mm projection (high copper content for additional strength)

### Application

SteelGuard, SecureGuard (Grades 1-4), Flame Guard, SoundGuard, MarineGuard, SportsGuard